

Working with Alexa

English
.....
Deutsch
.....
Français
.....
Italiano
.....
Español

1. Note before operation

- You need to have an Echo Show, and make sure it's online
- Please set up your cameras according to the user manual
- Please modify the camera nickname, nickname should be in English like: bedroom, office, home, house, baby, garden, shop etc.

2. Connect the camera to Alexa

Please open your Alexa APP, register an account and sign in, then follow the steps as below:

① Enter the Menu on the upper left corner

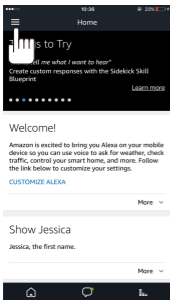

② Select "Skills"

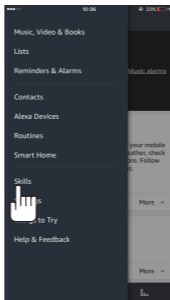

③ Search "MIPC"

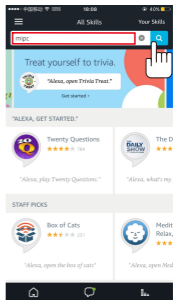

④ Tap on “MIPC” skill



⑤ Tap on “ENABLE”

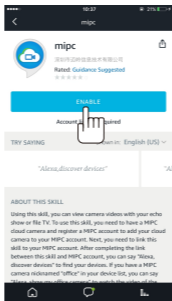

⑥ Sign in to your MIPC account

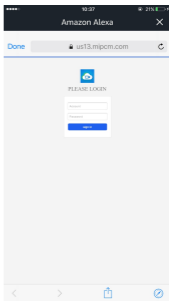

⑦ Close the “successfully linked” page

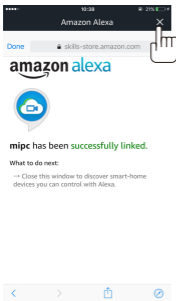

⑧ Tap on “DISCOVER DEVICES”

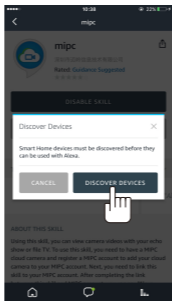

⑨ Check your device list

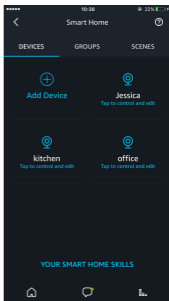

3. Voice Command supported by MIPC

Play live video of the camera

{Alexa}, {show} {bed room}

Note : Show could be changed to Hide, which command to stop playing live video.

1. Hinweise vor der Bedienung

- Sie müssen Aho Show kaufen und sich vergewissern, dass es online ist.
- Bitte schließen Sie Ihre Kamera gemäß der Bedienungsanleitung an.
- Bitte ändern Sie den Spitznamen bei der Verbindung der Kamera nach dem englischen Format, z. B. bedroom, office, home, house, baby, garden, shop usw.

2. Kamera mit Alexa verbinden

Bitte öffnen Sie die App Alexa, registrieren Sie das Amazon-Konto und loggen Sie sich ein. Danach bedienen Sie nach den folgenden Schritten:

① Klicken Sie auf die obere linke Menü-Schaltfläche.

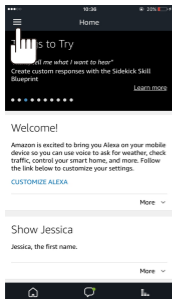

② Wählen Sie "Skills"

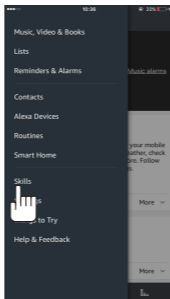

③ Suchen Sie "MIPC"

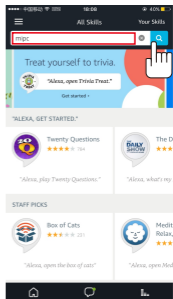

④ klicken Sie auf
"MIPC"

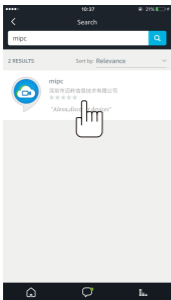

⑤ Klicken Sie auf
"ENABLE"

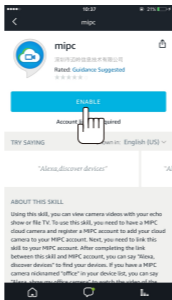

⑥ Loggen Sie sich
beim MIPC-Konto ein.

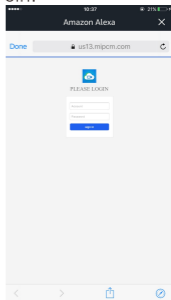

⑦ Schließen Sie
die Schnittstelle
"successfully linked"

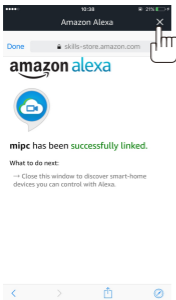

⑧ Klicken Sie auf
"DISCOVER
DEVICES"

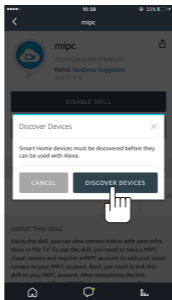

⑨ Geräteliste
anzeigen

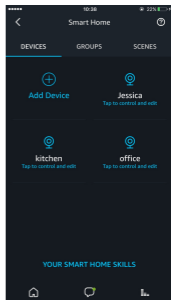

3. Von MIPC unterstützte Sprachbefehle

Live-Video der Kamera abspielen

{Alexa}, {show} {bed room}

Achtung: „Show“ kann als „Hide“ geändert werden. Dieser Befehl kann die Wiedergabe von Live-Videos beenden.

1. Instructions avant l'opération

- Vous devez avoir acheté Acho Show, et assurer qu'il reste en ligne.
- Veillez connecter votre caméra selon le guide d'opération.
- Durant la connexion de la caméra, veuillez modifier son surnom en caractères anglais, par exemple, office, home, house, camera, baby, shop, etc.

2. Connexion de la caméra avec Alexa

Veillez ouvrir l'application Alexa, vous inscrire et vous connecter à votre compte d'Amazon, et procéder aux opérations suivantes :

① Veuillez cliquer sur le bouton Menu au coin supérieur à gauche

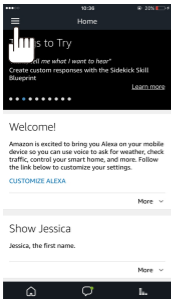

② Veuillez sélectionner « Skills »

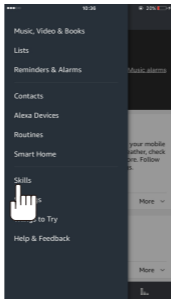

③ Veuillez saisir « MIPC » et procéder à la recherche

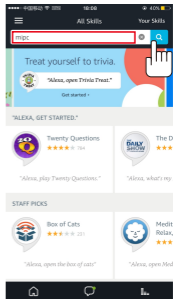

④ Veuillez cliquer sur la compétence « MIPC »

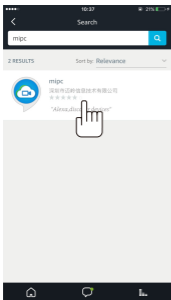

⑤ Veuillez cliquer sur «ENABLE »

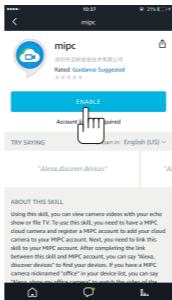

⑥ Veuillez vous connecter au compte de MIPC

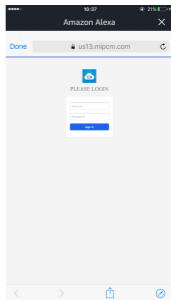

⑦ Veuillez fermer l'interface « successfully linked »

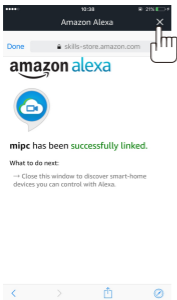

⑧ Veuillez cliquer sur « DISCOVER DEVICES »

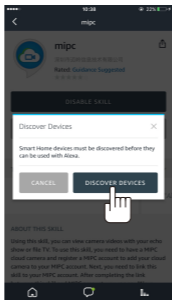

⑨ La liste des équipements sera affichée

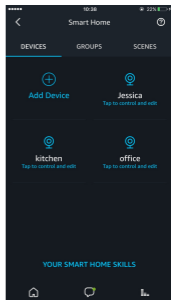

3. Commandes vocales supportées par MIPC

Lecture de vidéo en temps réel de la caméra

{Alexa}, {show} {bed room}

Attention : Vous pourrez modifier Show en Hide, cette commande pourra cesser la lecture de vidéo en temps réel.

1. Istruzioni prima dell'operazione

- È necessario acquistare Acho Show e garantire che sia online.
- Collegare la tua videocamera in base al manuale di uso.
- Si prega di modificare il soprannome in formato inglese quando si collega la videocamera, per esempio: bedroom, office, home, house, baby, garden, shop ecc.

2. Collegamento della videocamera con Alexa

Si prega di aprire Alexa APP per iscriversi e accendere con l'account di Amazon. Poi, si deve eseguire in base ai seguenti passaggi:

- 1 Cliccare sul pulsante in alto a sinistra del menù

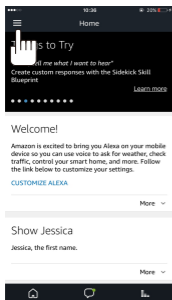

- 2 Selezionare "Skills"

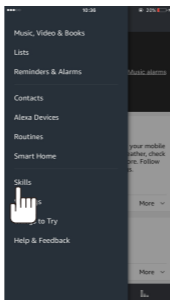

- 3 Inserire "MIPC" per la ricerca

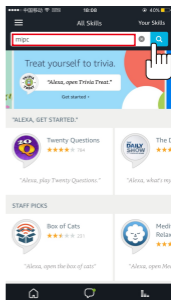

④ Premere l'abilità "MIPC"



⑤ Premere "ENABLE"

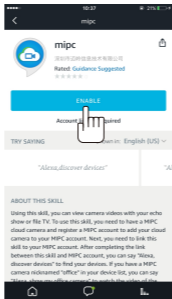

⑥ Accendere all' account MIPC

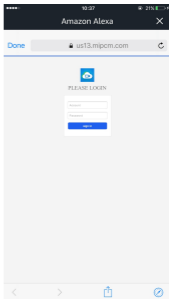

⑦ Chiudere l'interfaccia "successfully linked"

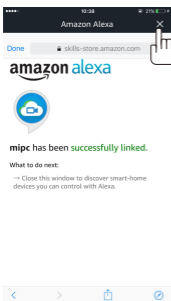

⑧ Premere "DISCOVER DEVICES"

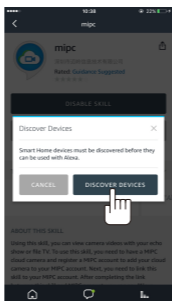

⑨ Visualizzare l'elenco dei dispositivi

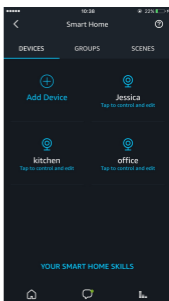

3. Comandi vocali supportati da MIPC

Riprodurre il video in diretta della videocamera

{Alexa}, {show} {bed room}

Nota : Show può essere modificato come Hide, questo comando può fermare la riproduzione del video in diretta.

1. Instrucción antes del uso

- Tiene que comprar Acho Show y manténgalo encendido.
- Conectar su cámara según la guía de operación.
- Cambiar el nombre por el en inglés cuando está conectando la cámara, por ejemplo: office, house, camera, baby, shop etc.

2. Conectar la cámara con Alexa

Abrir la aplicación Alexa, registrarse e iniciar sesión en su cuenta de Amazon, y luego operar de acuerdo con los siguientes pasos:

① Hacer clic en el botón de menú en la esquina superior izquierda

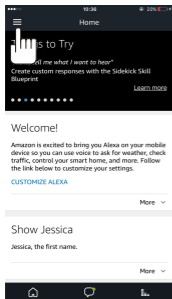

② Elegir "Skills"

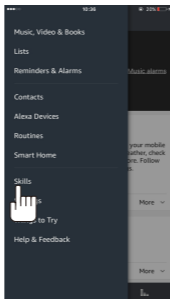

③ Ingresar "MIPC" en el cuadro de búsqueda

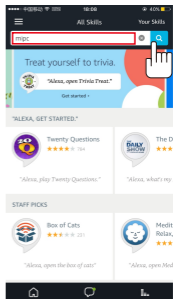

④ Hacer clic en las habilidades “MIPC”



⑤ Hacer clic en “ENABLE”

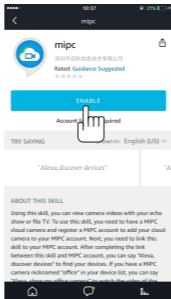

⑥ Iniciar sesión en la cuenta de MIPC

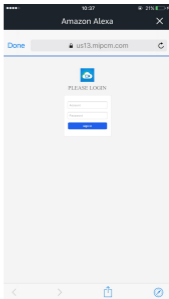

⑦ Cerrar el interfaz “successfully linked”

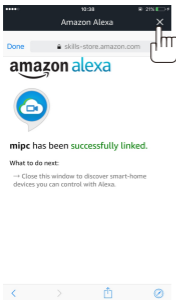

⑧ Hacer clic en “DISCOVER DEVICES”

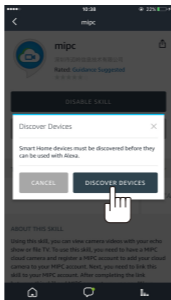

⑨ Mostrar la lista de dispositivos

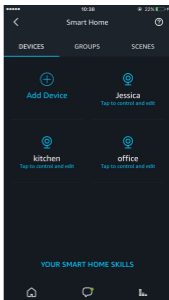

3. Denominación del audio apoyado por MIPC

Emitir los vídeos en vivo de la cámara

{Alexa}, {show} {bed room}

Nota: Show se puede cambiar por Hide, este orden puede detener la reproducción de los vídeos en vivo.